

REVISIONS				
SYM	DESCRIPTION	REVISED BY	DATE	APPR

FULL SECTION

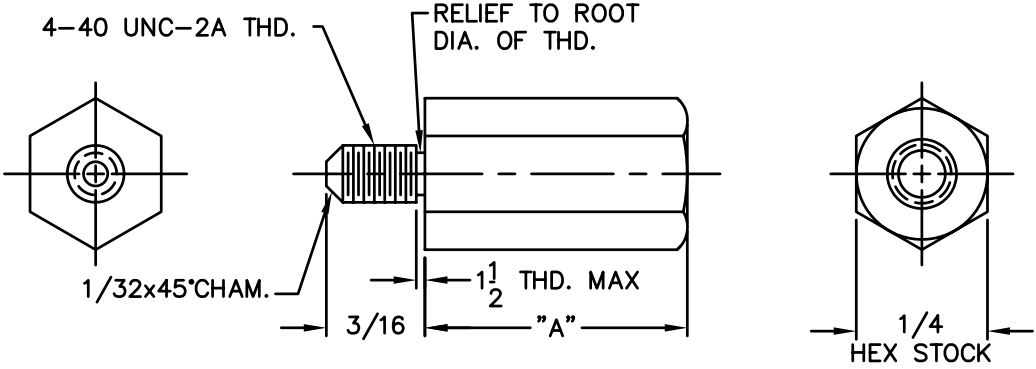
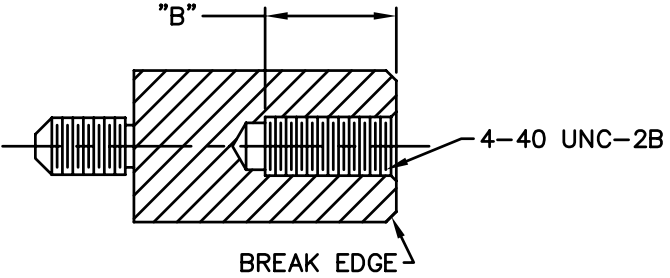

STANDOFF			
PART NO.	"A"	"B"	NO. THDS
8216	.250	.133	5-6
8217	.375	.250	8-9
8218	.500	.250	10-11
8219	.625	.250	10-11
8220	.750	.250	10-11
8221	.875	.250	10-11
8222	1.000	.250	10-11
8223	1.125	.250	10-11
8224	1.250	.250	10-11
8225	1.375	.250	10-11
8226	1.500	.250	10-11
8227	1.625	.250	10-11
8228	1.750	.250	10-11
8229	2.000	.250	10-11
8230	2.500	.250	10-11
8231	3.000	.250	10-11

MATERIAL: BRASS-ALLOY 360- 1/2 HARD		FINISH: NICKEL CODE#10		<h1>ABBATRON</h1> <p>Electronic Connectors and Hardware 632 Arch Street, Meadville, Pa. 16335</p>			
DIMENSIONAL TOLERANCES UNLESS OTHERWISE SPECIFIED			TITLE: 8216-8231				
.XX	.XXX	.XXX	BRASS HEX MALE/FEMALE STANDOFF				
---	---	---					
FRACTIONS		ANGLES	SCALE				
---		---	4X				
HEAT TREAT: ---		DRAWN: T. LORD		DATE: 01/7/03	SIZE	DRAWING NUMBER	ISSUE
PLOT SCALE: 1=1		CHECKED: T. LORD		DATE: 01/7/03	B	SD: 8216-8231	P
		APPROVED: T.LORD		DATE: 01/7/03			