

PART#	"A"
8821R	1.125
8821S	1.250
8821T	1.375
8821U	1.500
8821V	1.625
8821W	1.750
8821X	1.875
8821Y	2.000

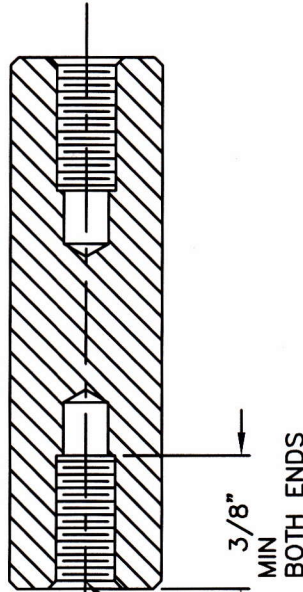
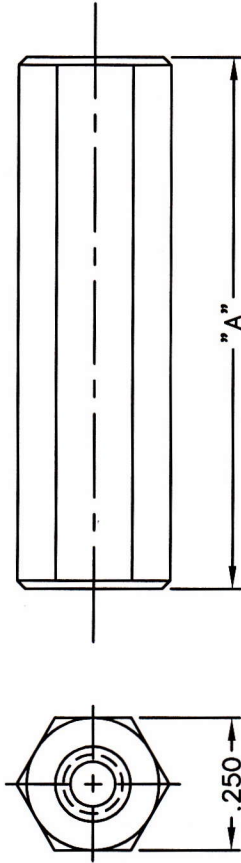

6-32 UNC-2B THD
BOTH ENDS

MATERIAL: BRASS 360 1/2 HARD		FINISH: NICKEL	HEAT TREAT: ---
DIMENSIONAL TOLERANCES UNLESS OTHERWISE SPECIFIED		TITLE: 8821R-Y	
.XX	.XXX	.XXXX	BRASS HEX STANDOFF 6-32 THD, BLIND
±.01	±.005	---	
FRACTIONS	ANGLES	SCALE	
±1/64	±1°	---	
SURFACE FINISH		DRAWN: T. LORD DATE: 2/17/06	
125		CHECKED: T. LORD DATE: 2/17/06	
.002		APPROVED: T. LORD DATE: 2/17/06	
SIZE: A			ISSUE: P
DRAWING NUMBER: SD 8821R-Y			

ABBATRON

Electronic Connectors and Hardware
13680 S. MOSIERTOWN RD
MEADVILLE, PA 16335

THIS DRAWING AND THE INFORMATION THEREIN IS THE PROPERTY OF ABBATRON, LLC AND ALL UNAUTHORIZED USE OR REPRODUCTION THEREOF IS PROHIBITED.